

1



- 1) N° NOT714
- 2) N° NOT618
- 3) N° NOT718
- 4) N° NOT722
- 5) N° NOT724
- 6) N° NOT474



PROCITY

N° OF :

FRANCE: +33.(0)2.54.80.32.99
EXPORT: +33.(0)1.39.08.26.55



ABRI FUMEUR - MILAN Lg.2500

Poteaux 80x80, 1 Bardage de Fond, 2 Bardages Latéraux et 1 Retour Avant - Réf.529405

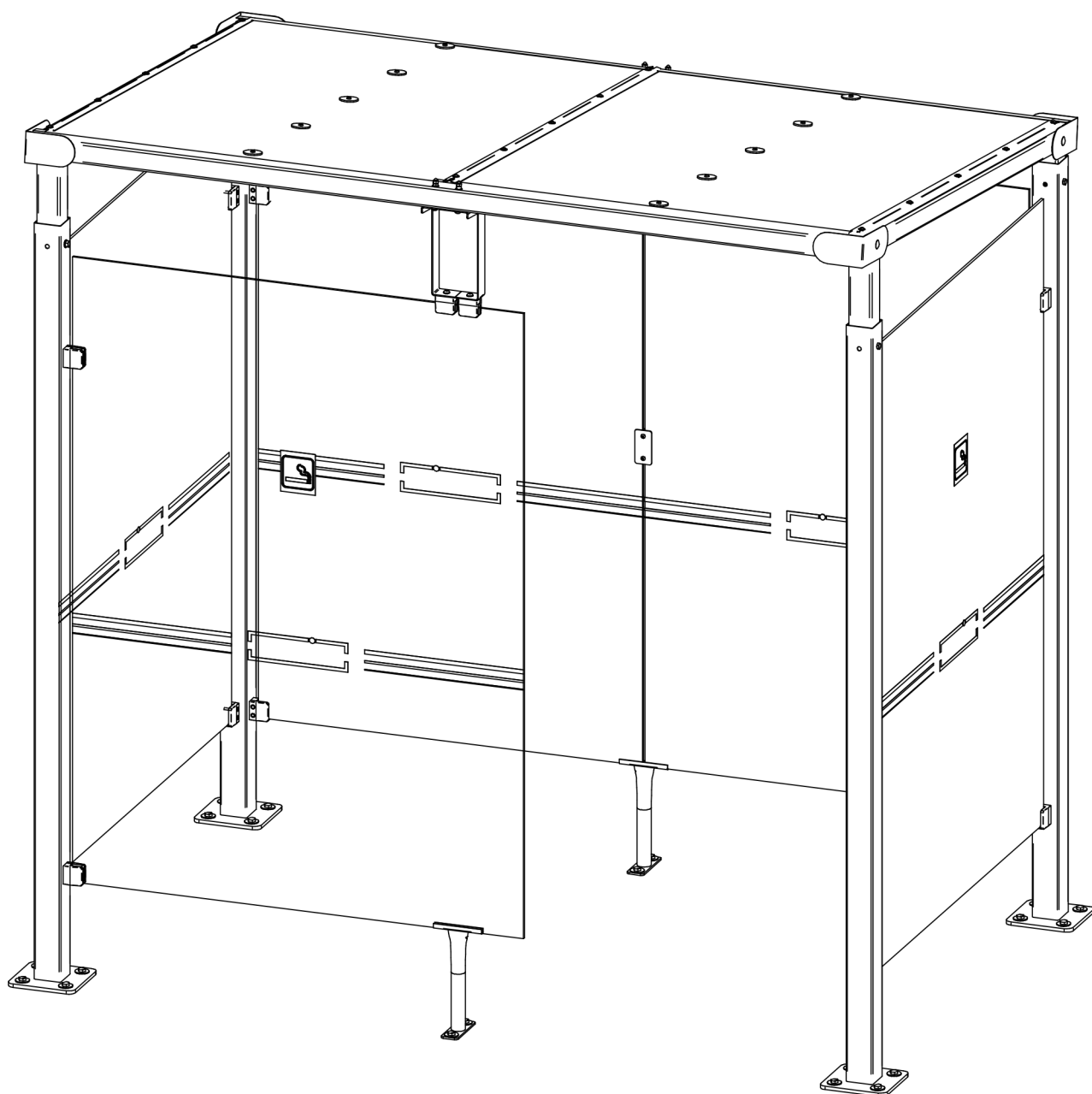

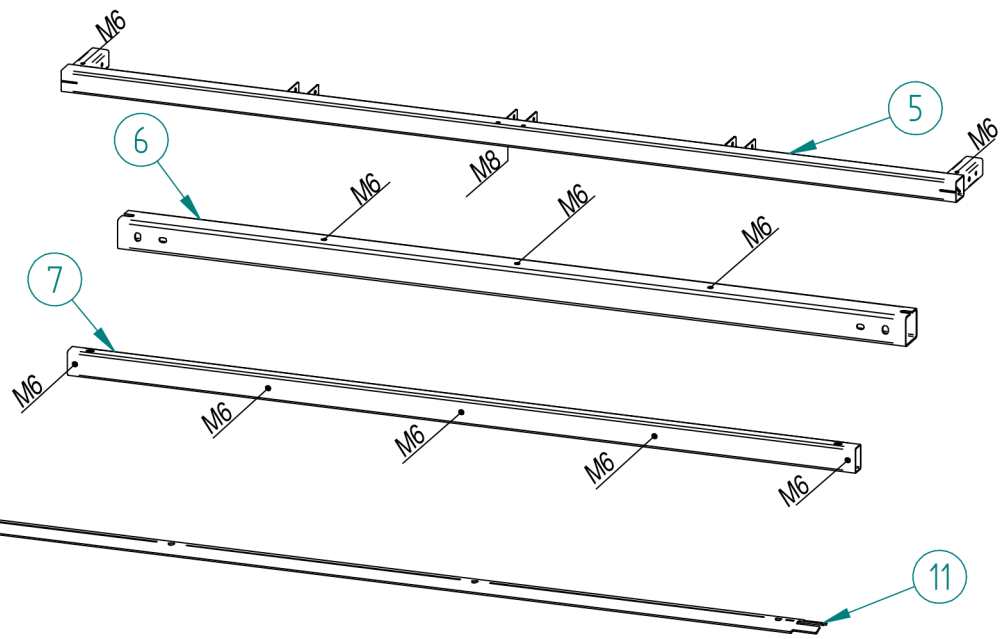
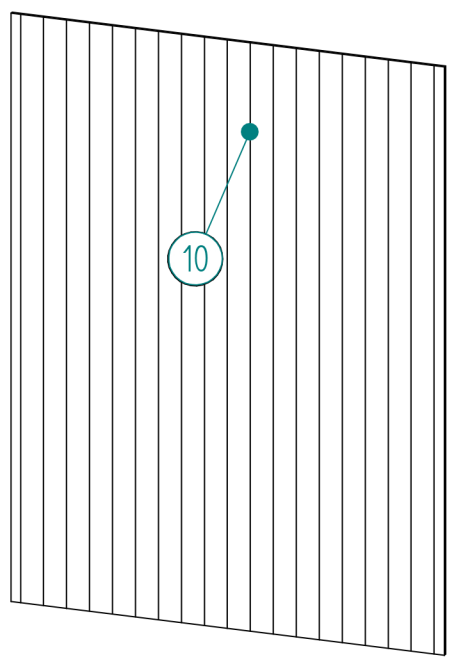
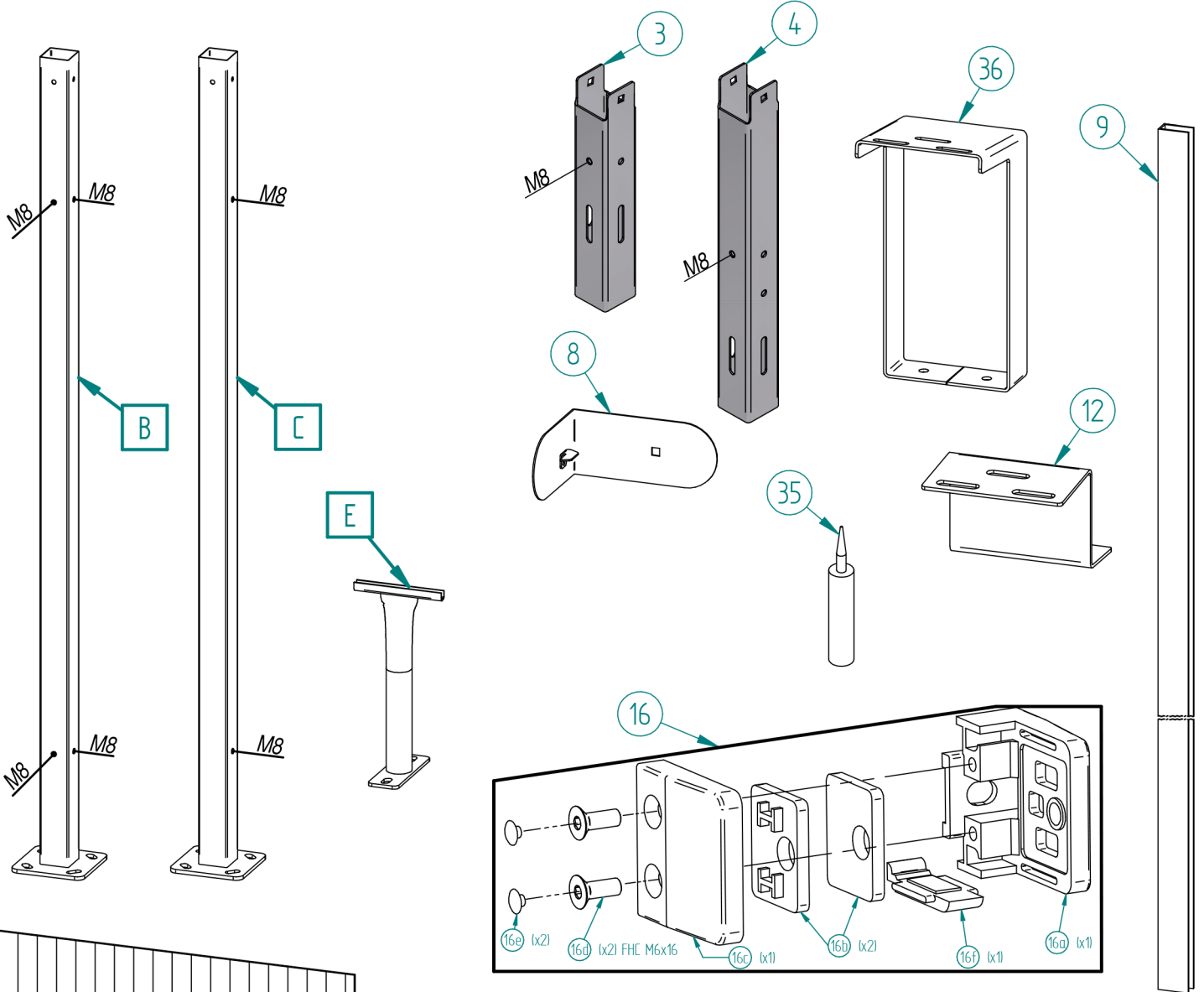

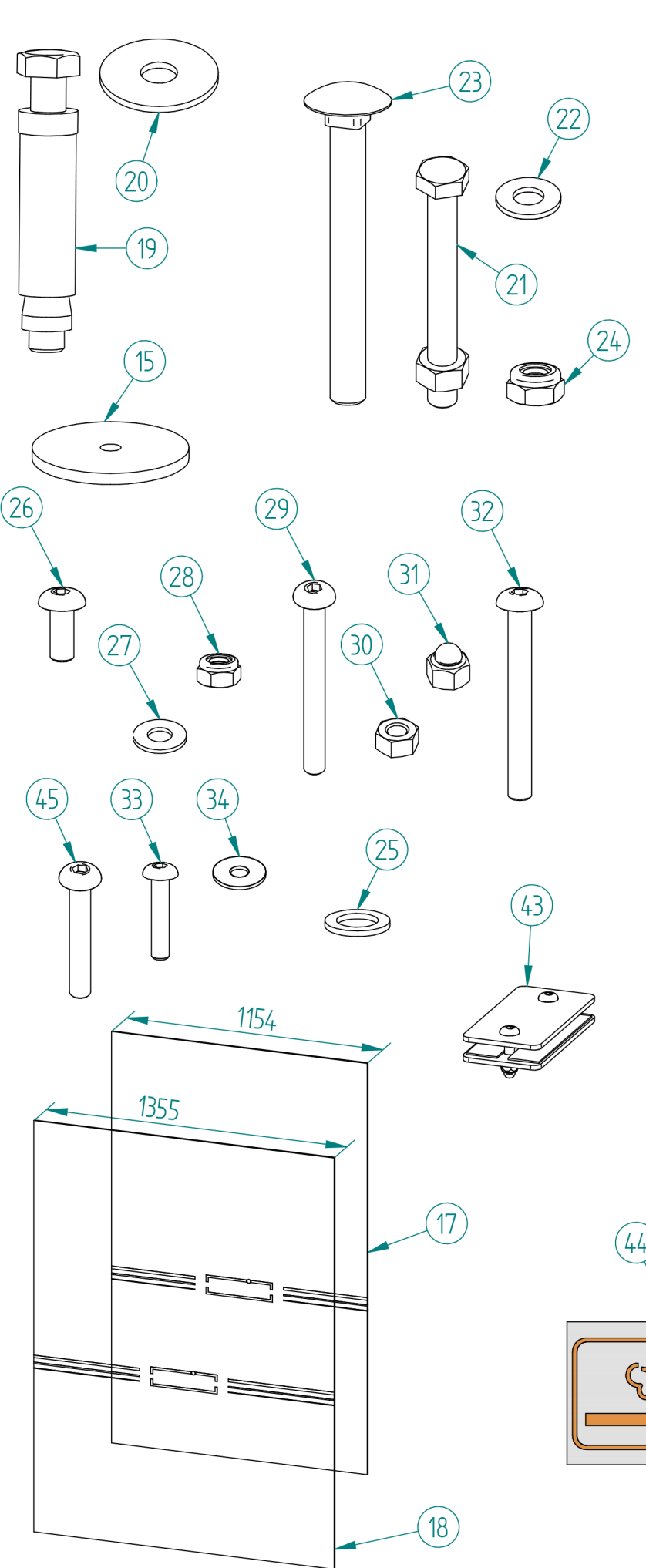

| | | | |
|----------|--------------|------------|---|
| 45 | ACC22035 | 10 | Vis BHC M6x40 Inox A2-70 |
| 44 | ACC01015 | 3 | Adhésif "Fumeur" |
| 43 | SFI529301-B | 1 | PINCE ENTRE VITRAGE |
| 36 | SFI529405-05 | 1 | PATTE DE FIXATION SUP. VITRE TOITURE |
| 35 | ACC19111 | 1 | SILICONE TRANSLUCIDE |
| 34 | ACC18081 | 15 | Rondelle Plate Ø6L A2 |
| 33 | ACC220216 | 15 | Vis BHC M6x20 Inox A2-70 |
| 32 | ACC22185 | 10 | Vis BHC M8x70 A2-70 |
| 31 | ACC04986 | 14 | Ecrou M8 Frein Borgne A2-70 |
| 30 | ACC05012 | 4 | Ecrou H M8 A2 |
| 29 | ACC02144 | 4 | Vis BHC M8x80 A2-70 |
| 28 | ACC04981 | 4 | Ecrou M8 frein bague nylon A2 |
| 27 | ACC18145 | 34 | Rondelle Ø8M A2-70 |
| 26 | ACC22226 | 20 | Vis BHC M8x20 A2-70 |
| 25 | ACC18120 | 4 | Rondelle Plastique Ø14,1xØ22x2 |
| 24 | ACC05038 | 4 | Ecrou frein M10 Inox |
| 23 | ACC220362 | 4 | Vis RCC M10x90 Inox A2-70 |
| 22 | ACC18143 | 8 | Rondelle M10 - ZN |
| 21 | ACC02174 | 4 | Boulon H M10x90 - ZN |
| 20 | ACC18130 | 20 | Rondelle large LL12 A2-70 |
| 19 | ACC03322 | 20 | Cheville à expansion M12 |
| 18 | VIT81125-02 | 3 | VERRE SECURIT 1860x1355 |
| 17 | VIT81123-02 | 2 | VERRE SECURIT 1860x1154 |
| 16 | ACC16127 | 18 | PINCE A VERRE AVEC SABOT |
| 15 | ACC529260-01 | 10 | ATTACHE ALVEOLAIRE Ø53 |
| 12 | SFI529240-05 | 1 | PATTE DE FIXATION BARDAGE VERRE DE FOND |
| 11 | SFI529240-04 | 3 | TOLE DE FIXATION ALVEOLAIRE Lg.1650 |
| 10 | SFI529240-03 | 2 | ALVEOLAIRE DE TOITURE 1210x1650x10 |
| 9 | SFI529255-J | 2 | U POUR ALVEOLAIRE Lg.2498 AVEC JOINT |
| 8 | SFI529255-E | 4 | TOLE DE FINITION D'ANGLE AVEC CALE |
| 7 | SFI529240-D | 3 | TRAVERSE CENTRALE EQUIPEE |
| 6 | SFI529240-C | 2 | TRAVERSE D'EXTREMITE EQUIPEE AVEC INSERTS |
| 5 | SFI529255-R | 2 | POUTRE EQUIPEE POUR ABRI MILAN |
| 4 | SFI529255-Q | 2 | SUPPORT DE TOIT AVANT EQUIPE |
| 3 | SFI529255-P | 2 | SUPPORT DE TOIT ARRIERE EQUIPE |
| E | SFI529300-14 | 2 | PIED POUR BARDAGE DE STATION BUS |
| C | SFI529309_12 | 1 | POTEAUX 80x80 Lg.2260 + 2 FIXATIONS |
| B | SFI529309_13 | 3 | POTEAUX 80x80 Lg.2260 + 4 FIXATIONS A 90° |
| X | N° | Références | Qté Description |

PROCITY = (x0)

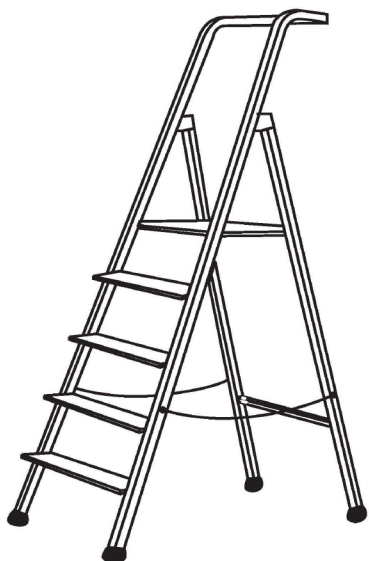
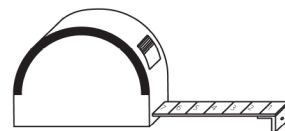
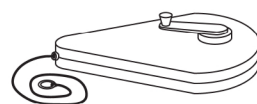
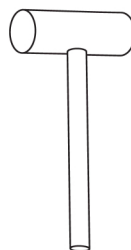
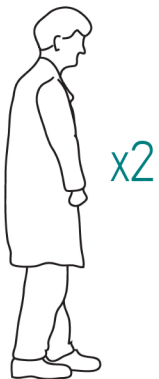

∅7
∅20

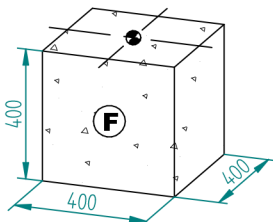
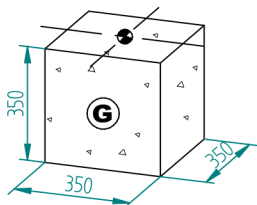
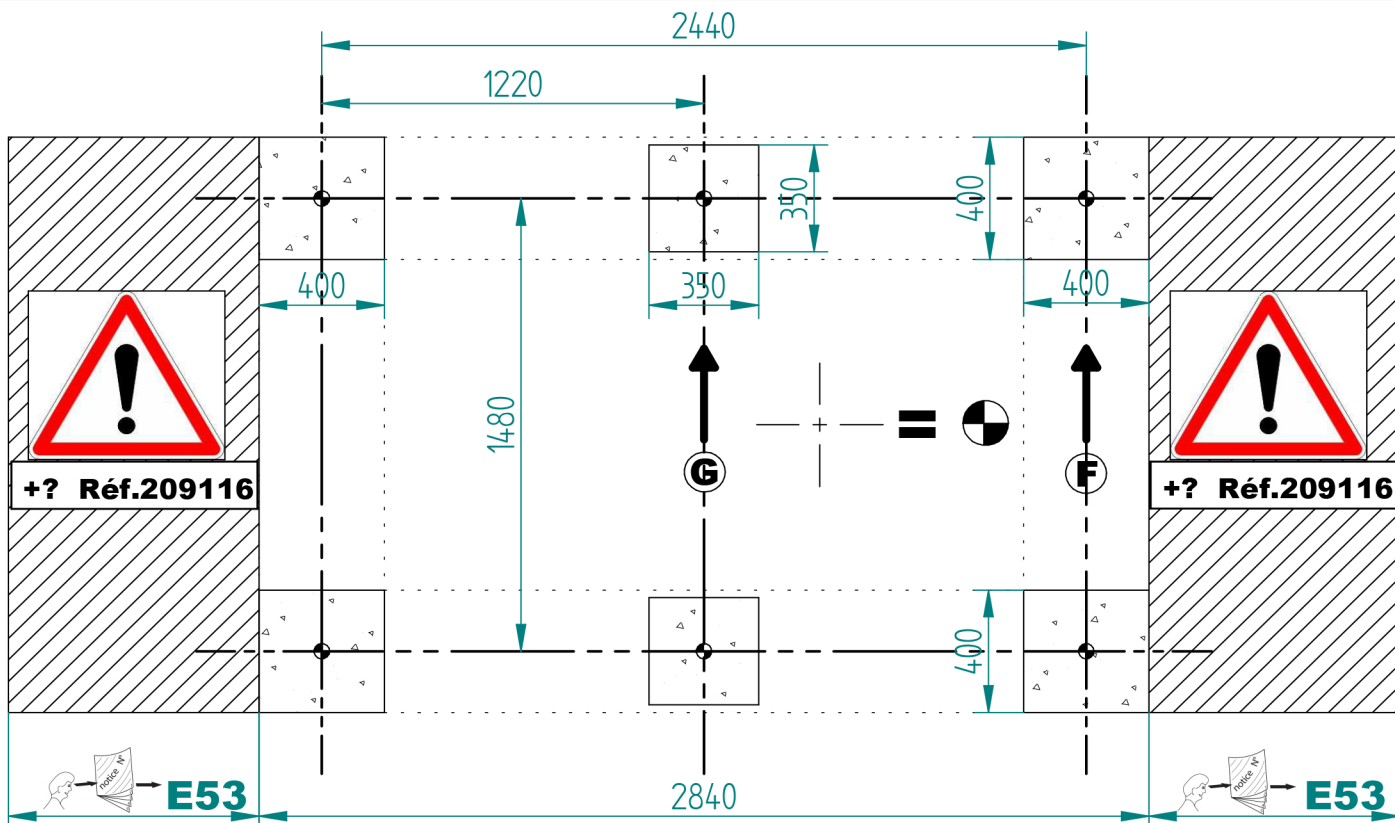
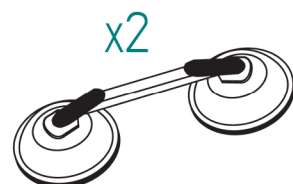
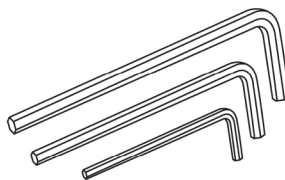
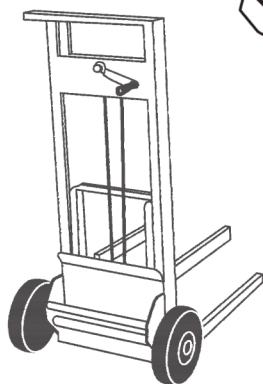
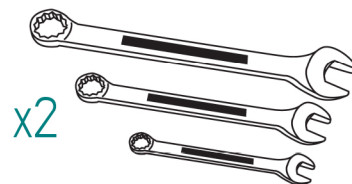

Positionnement et Fixation Poteaux : Abri Fumeurs 80x80

1 Bardage de Fond, 2 Bardages Latéraux et 1 Retour Avant (1 Module)

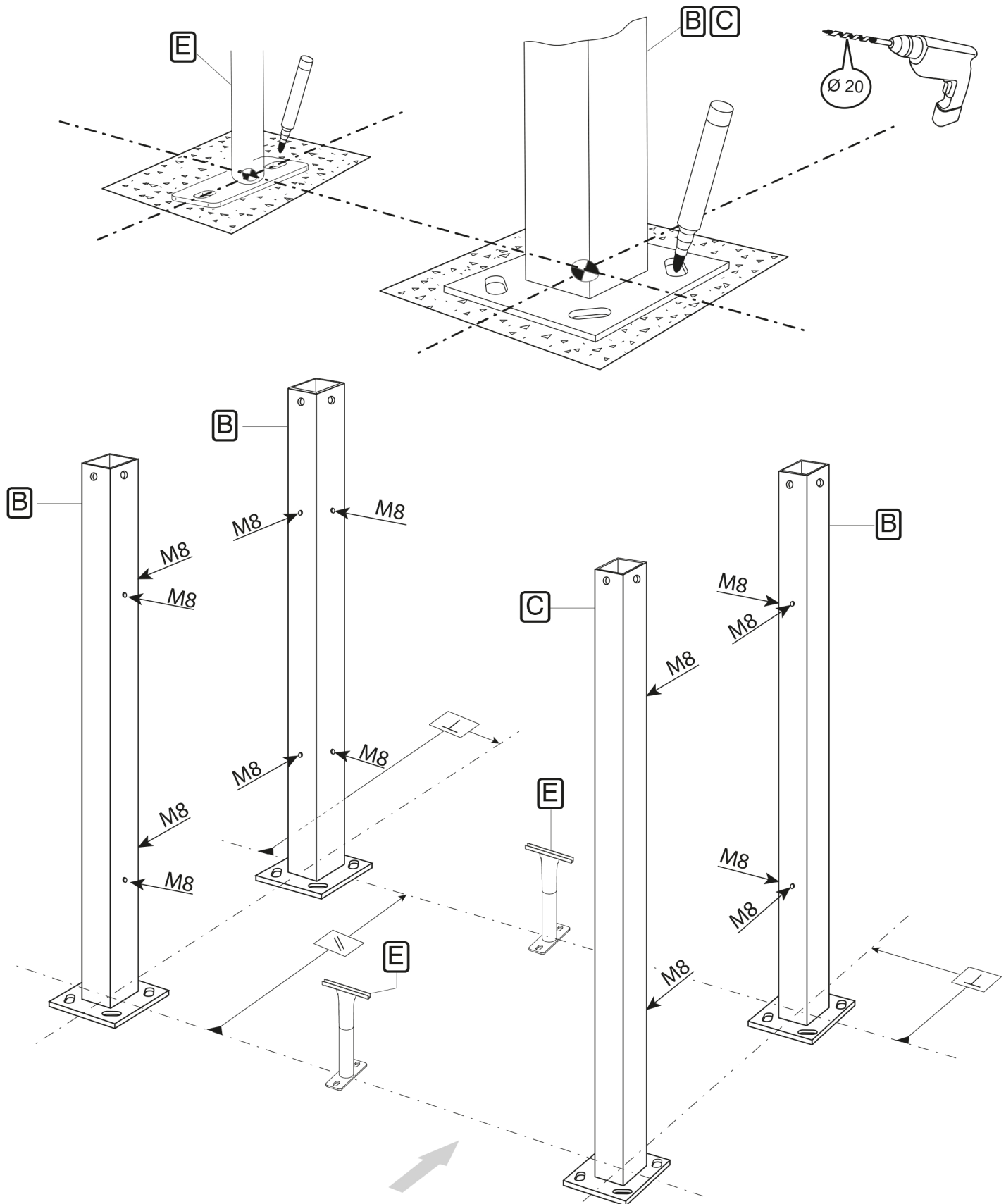

Montage Poteaux & Traverses ABRI - FUMEURS (1 Module)

1

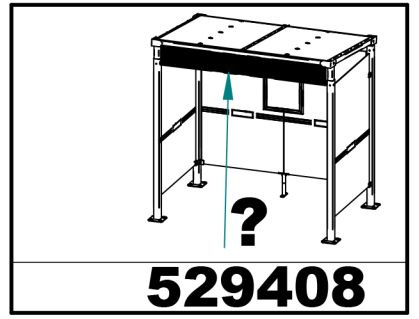
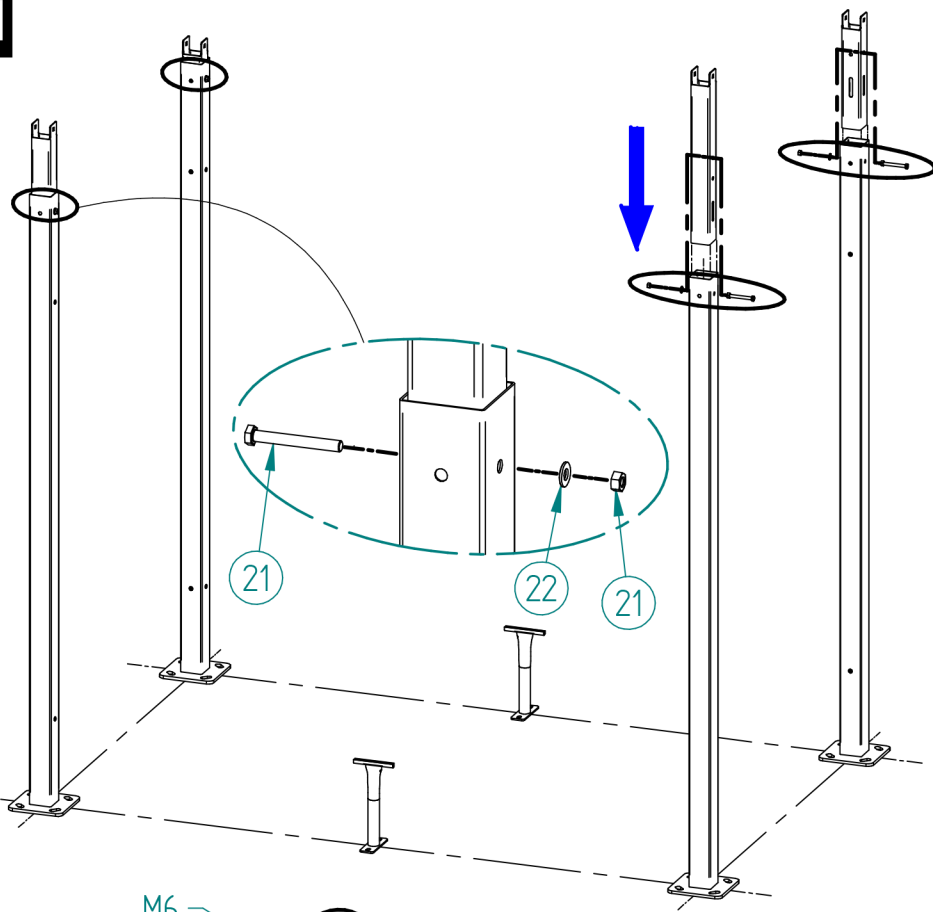

§ 3 -> N°727

- 21 -> 129
- 22 -> 128

2

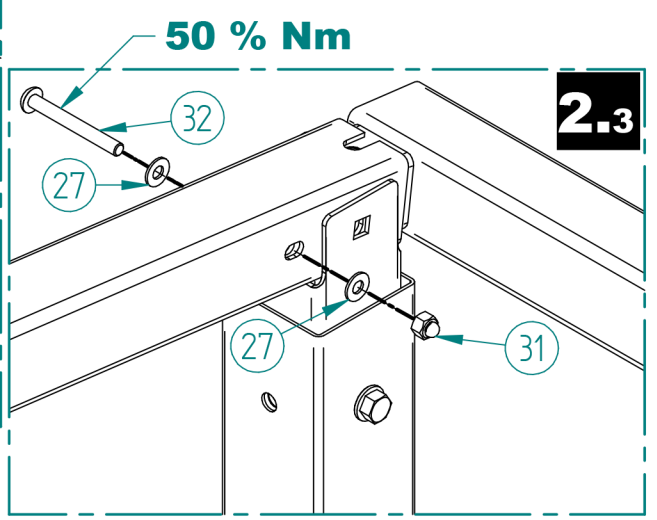
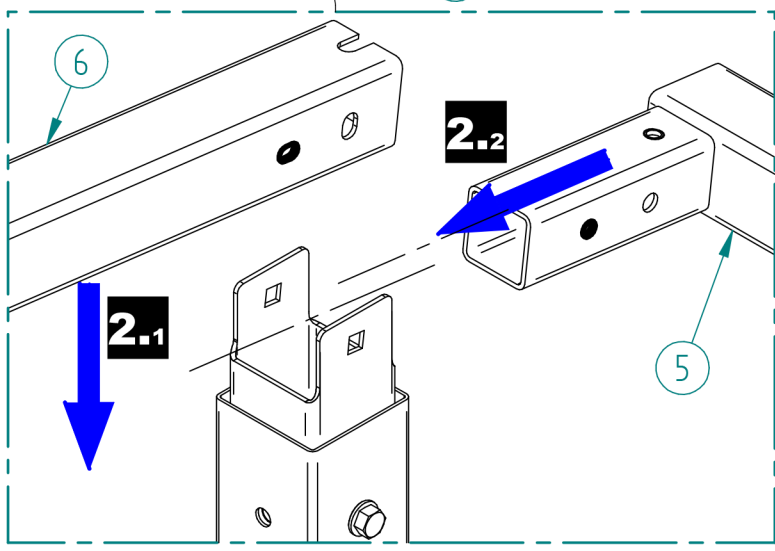
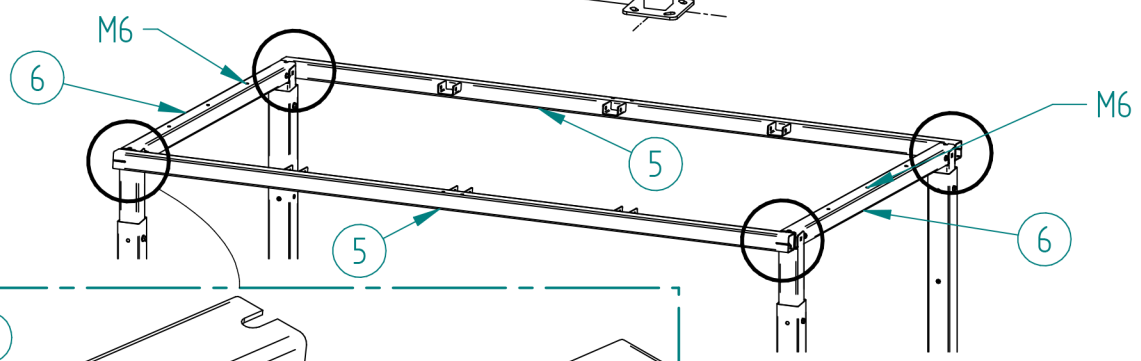

3

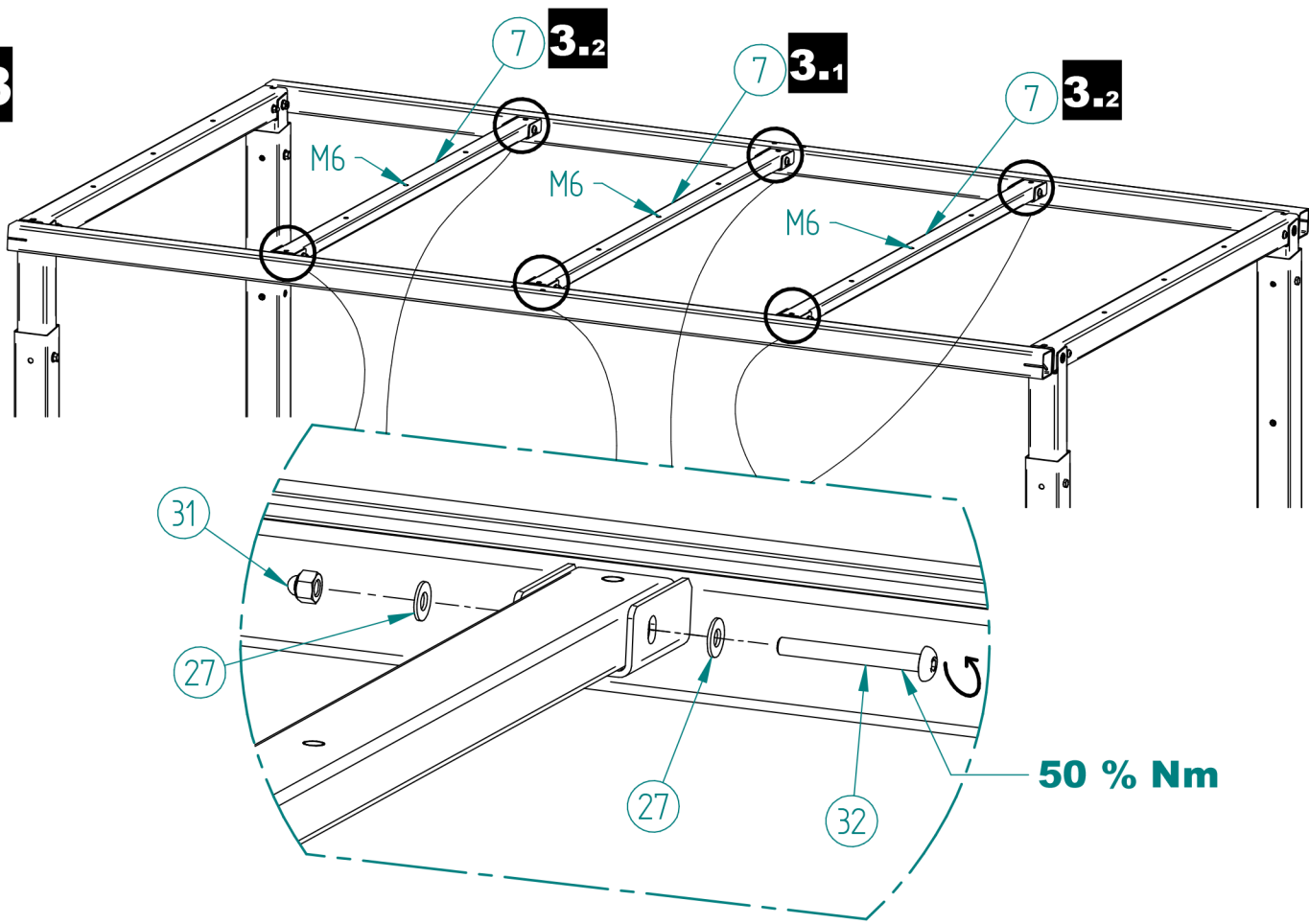

4

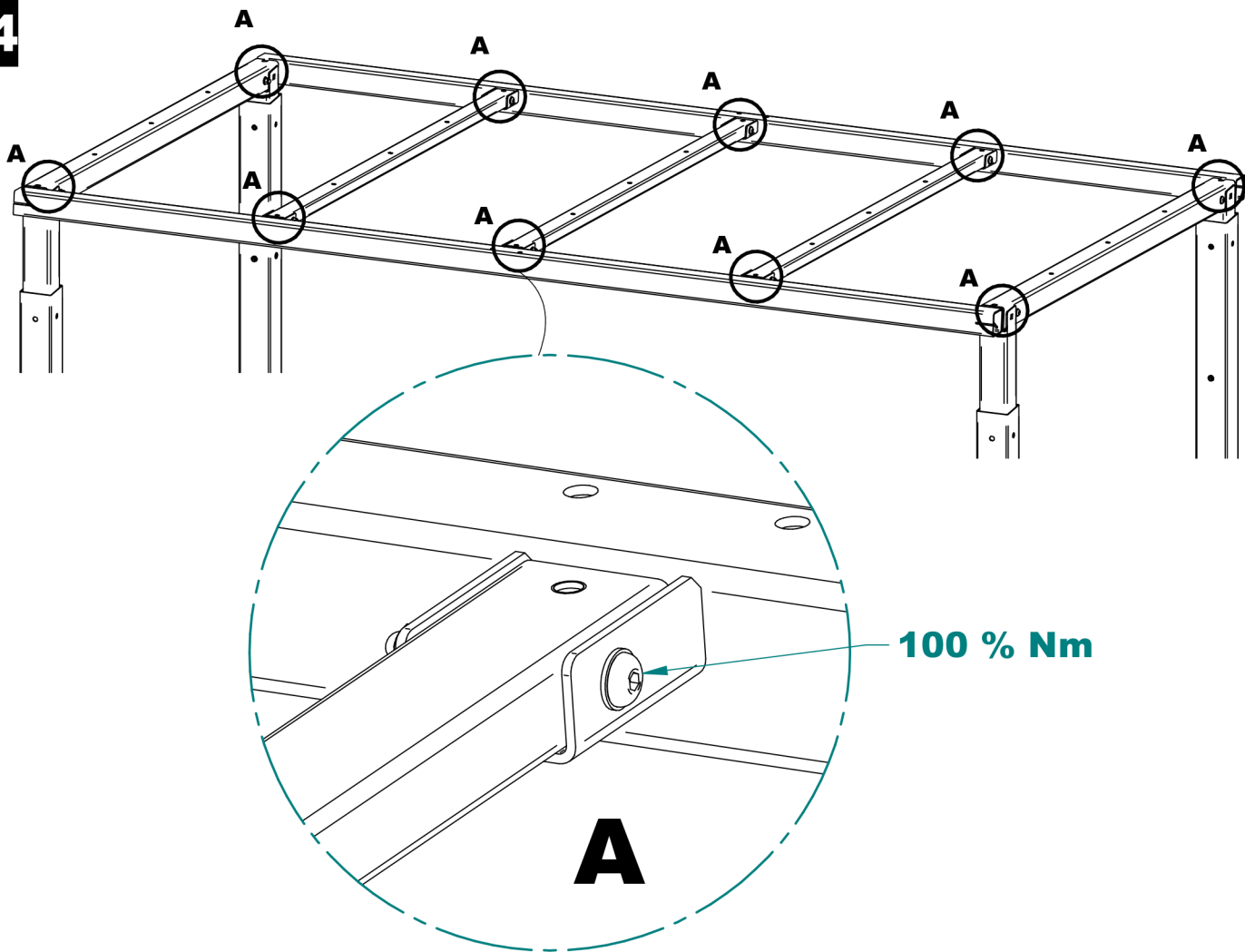

5

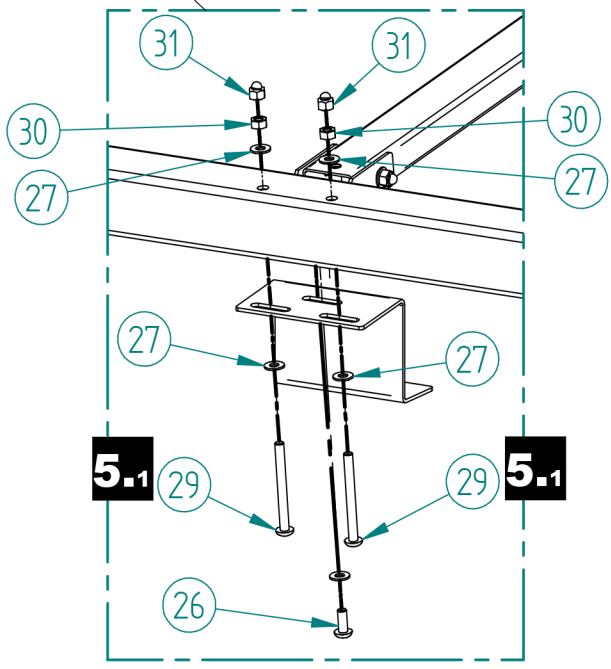
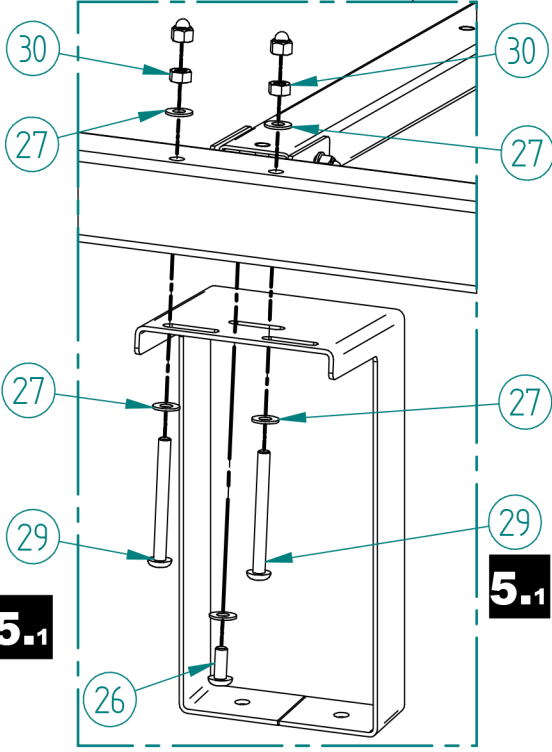
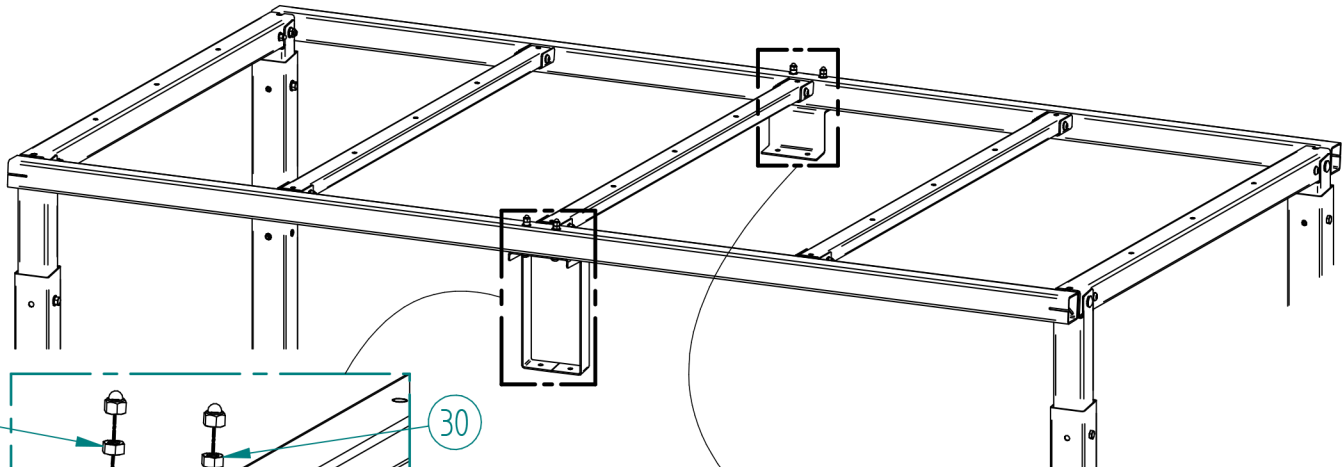

6

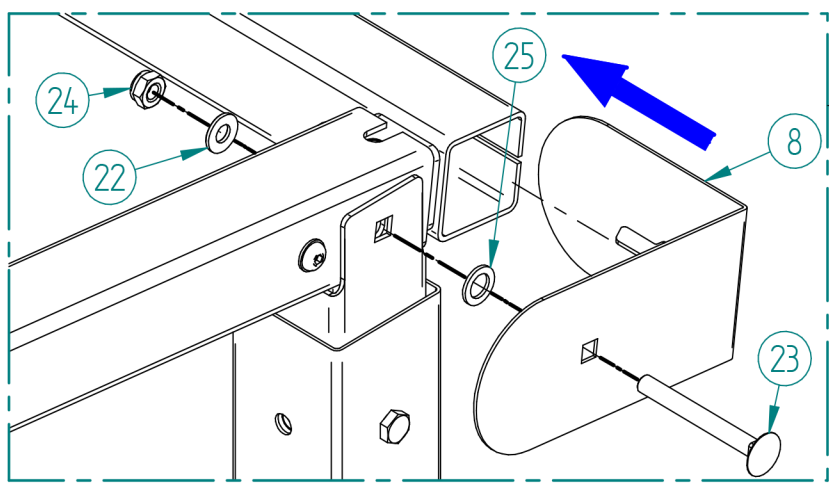
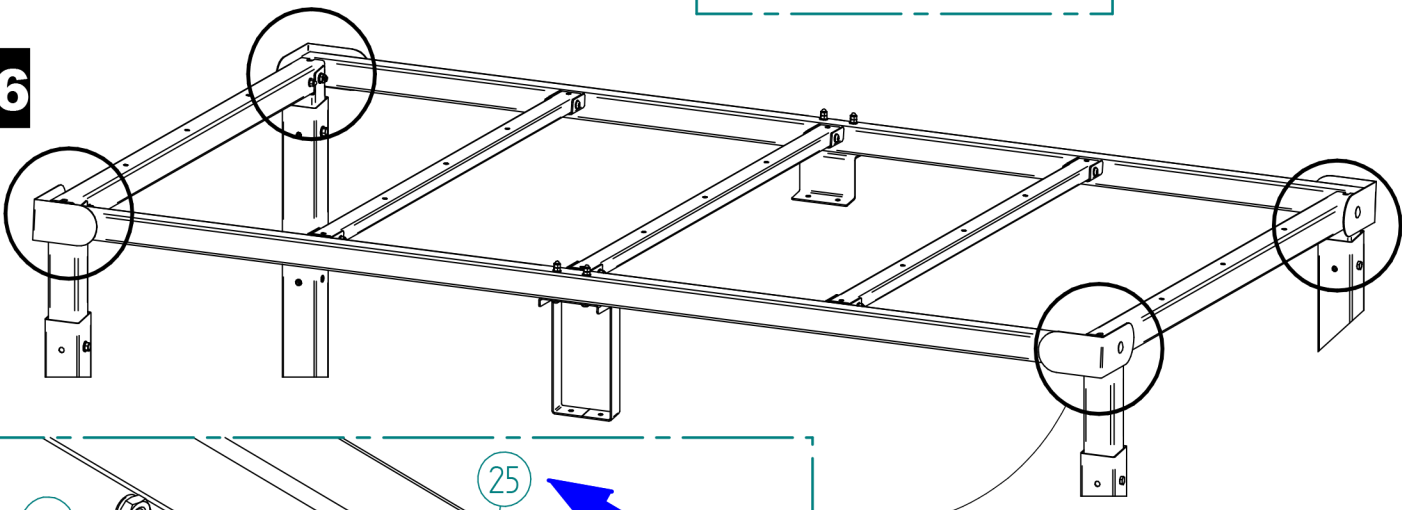

Montage Toiture STATION-BUS MILAN

1

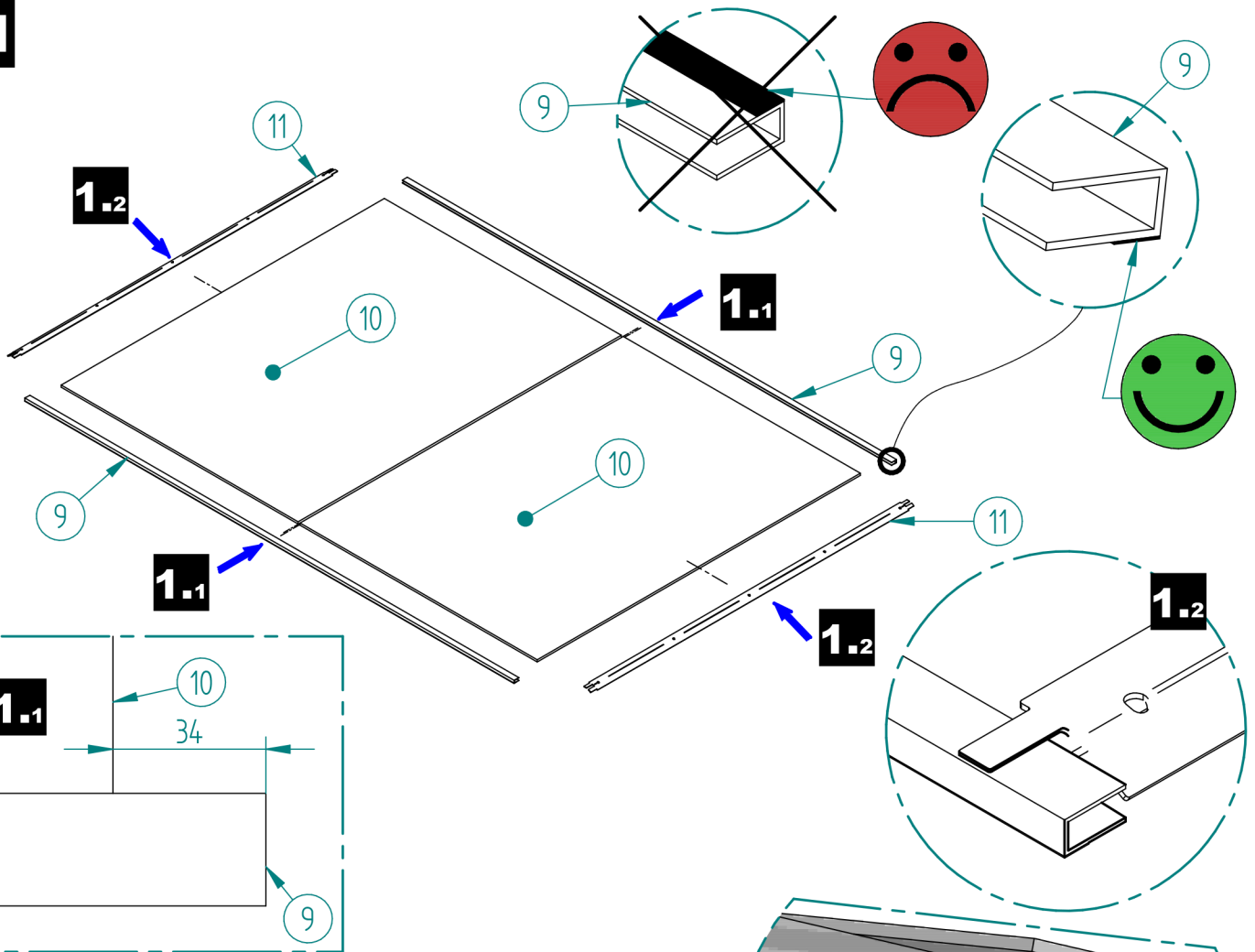

2

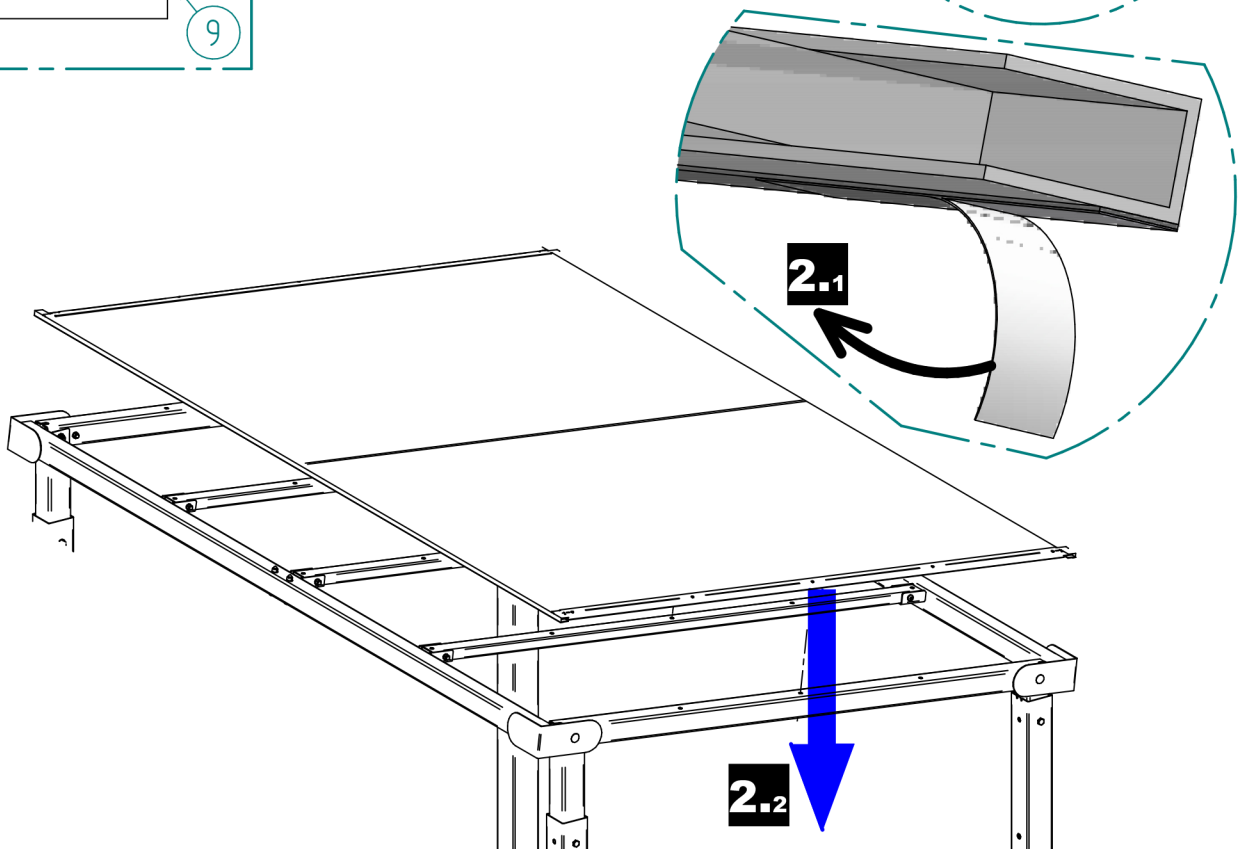

3

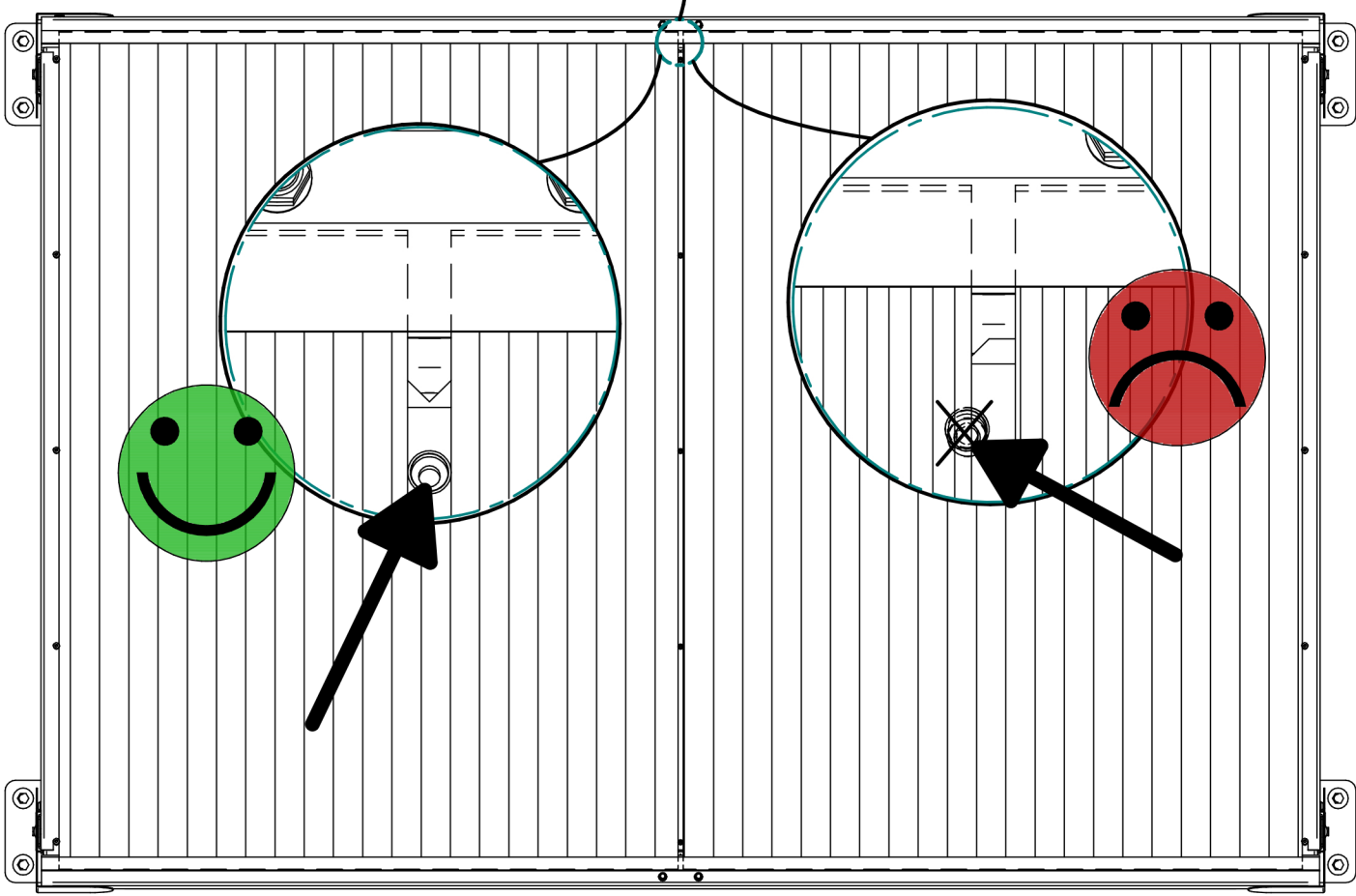
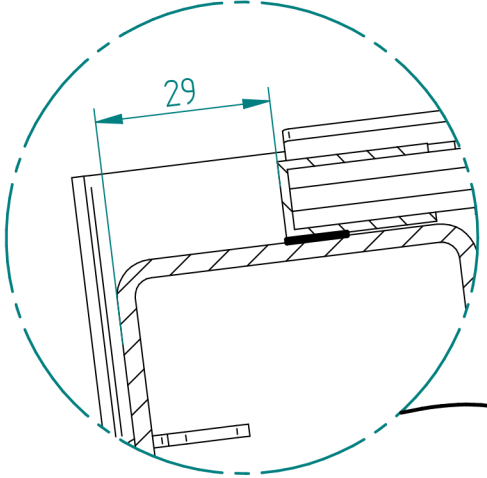

4

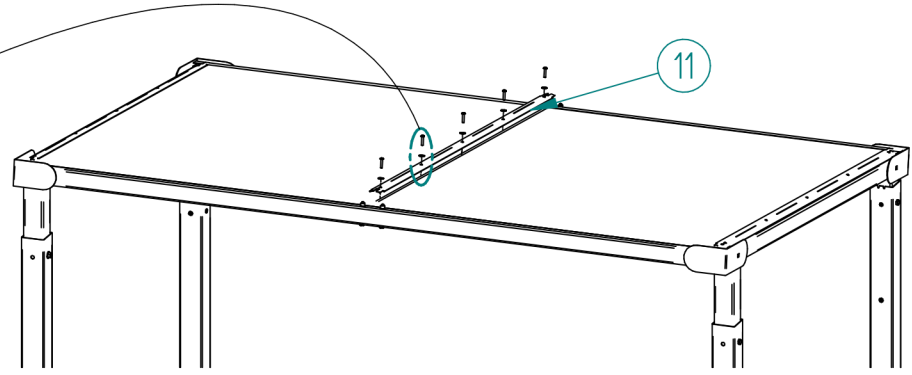
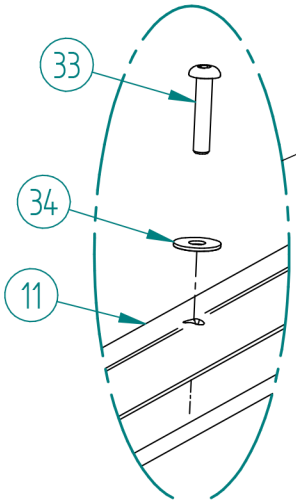

4

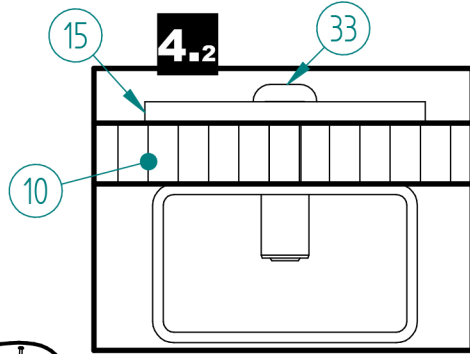
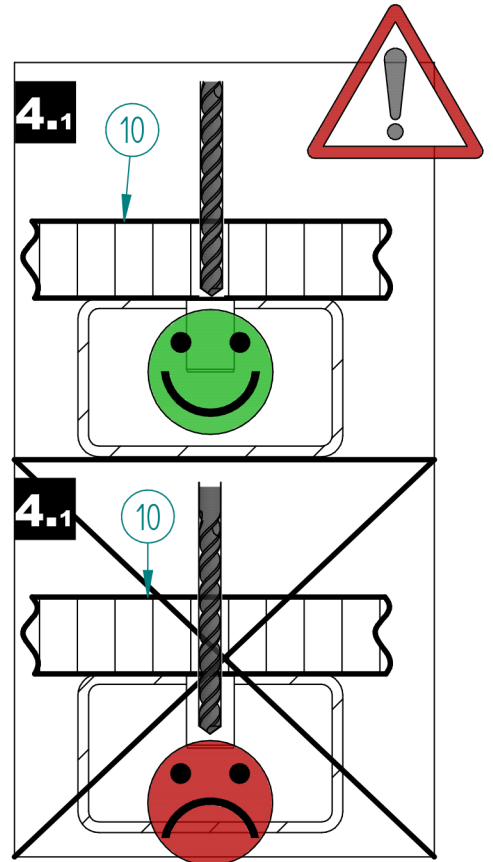
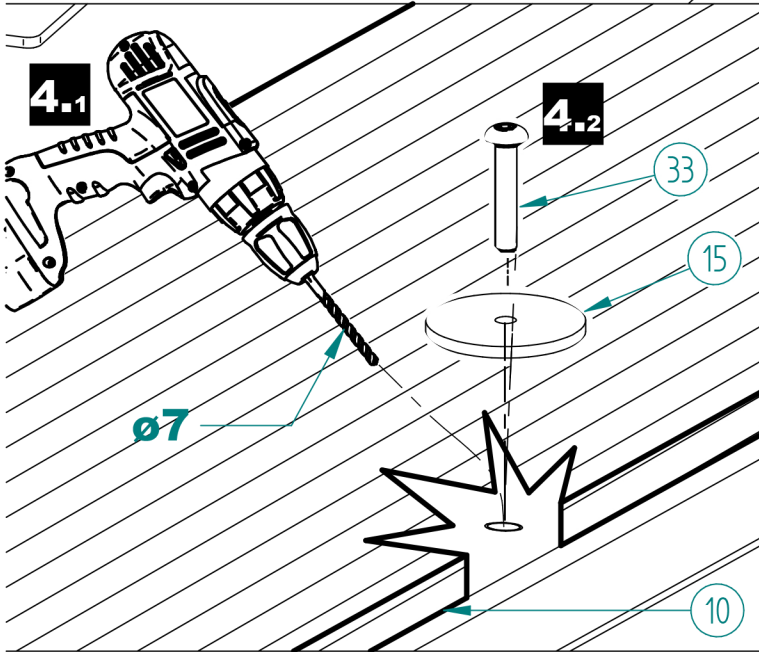
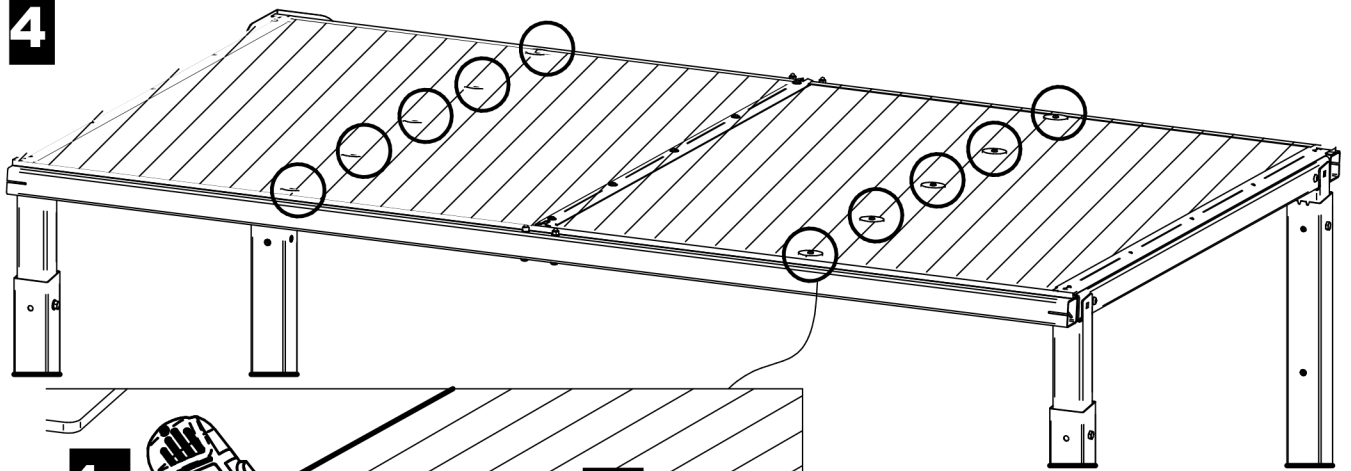

5

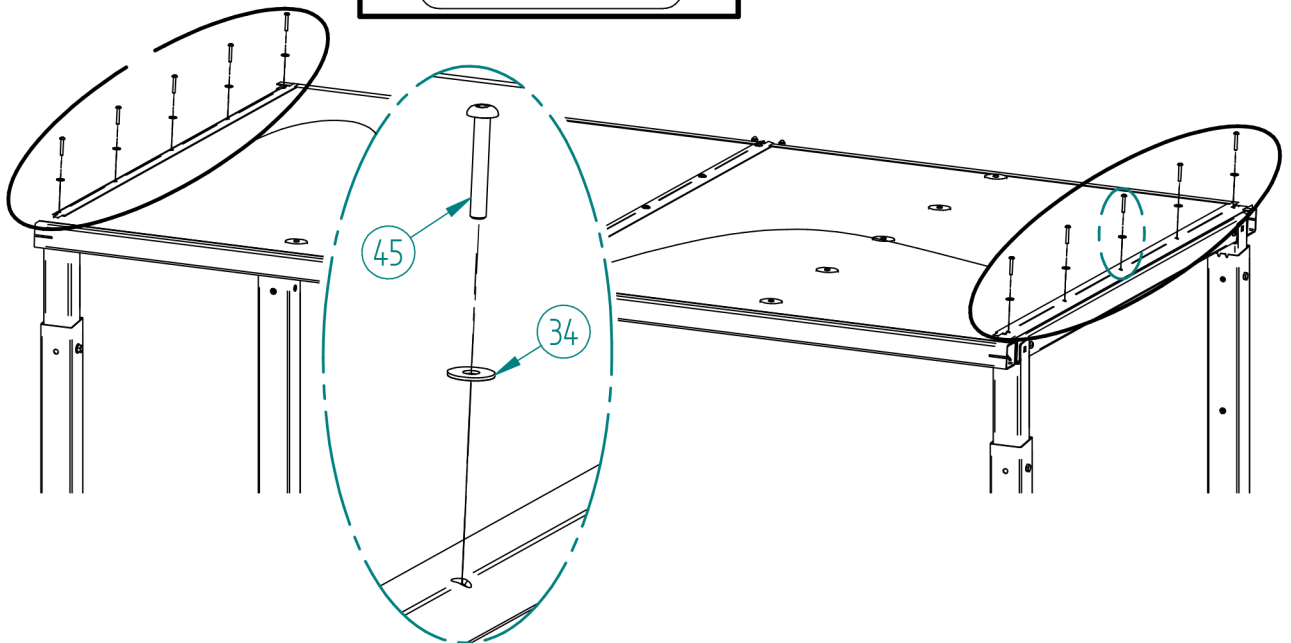

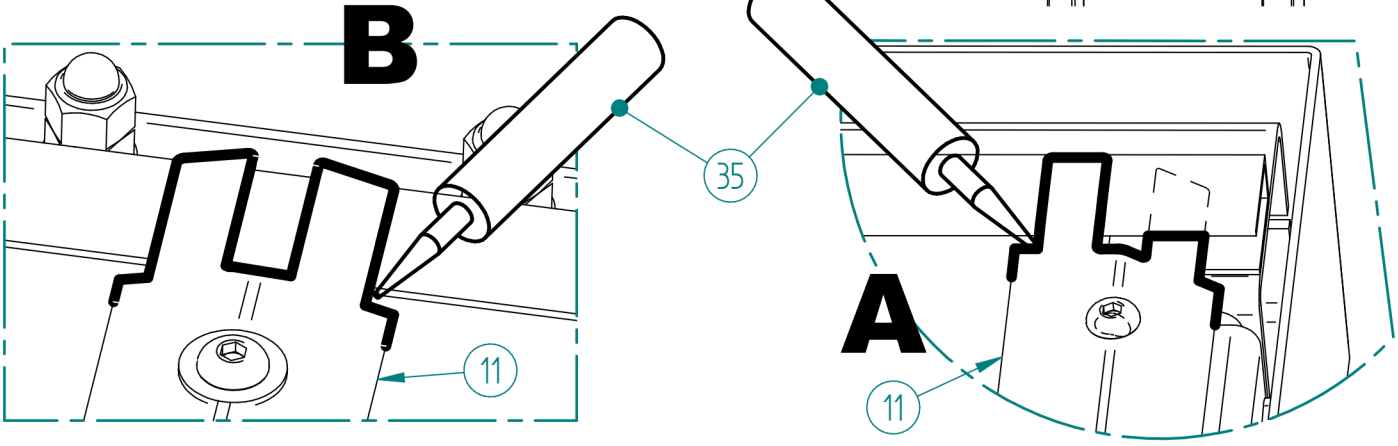
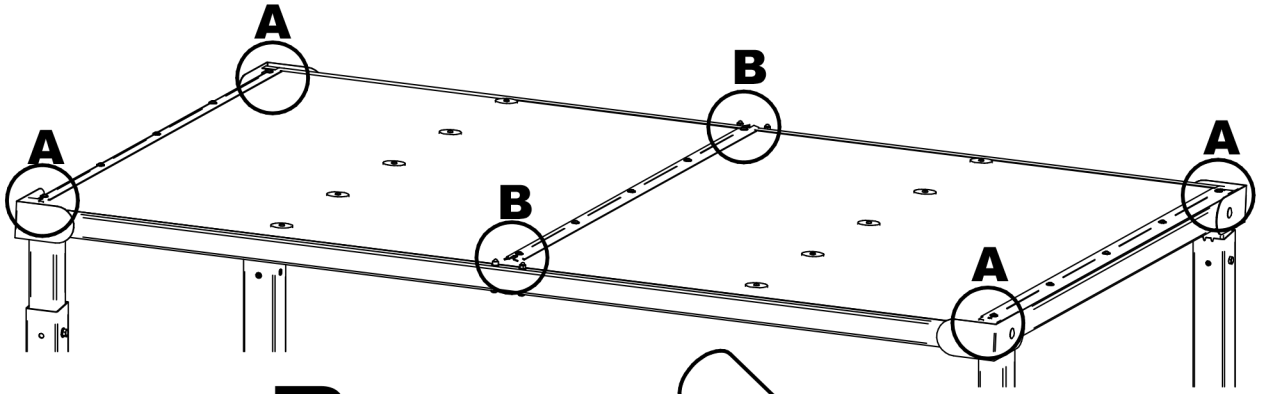

Montage Bardage

ABRI & STATION-BUS MILAN

1

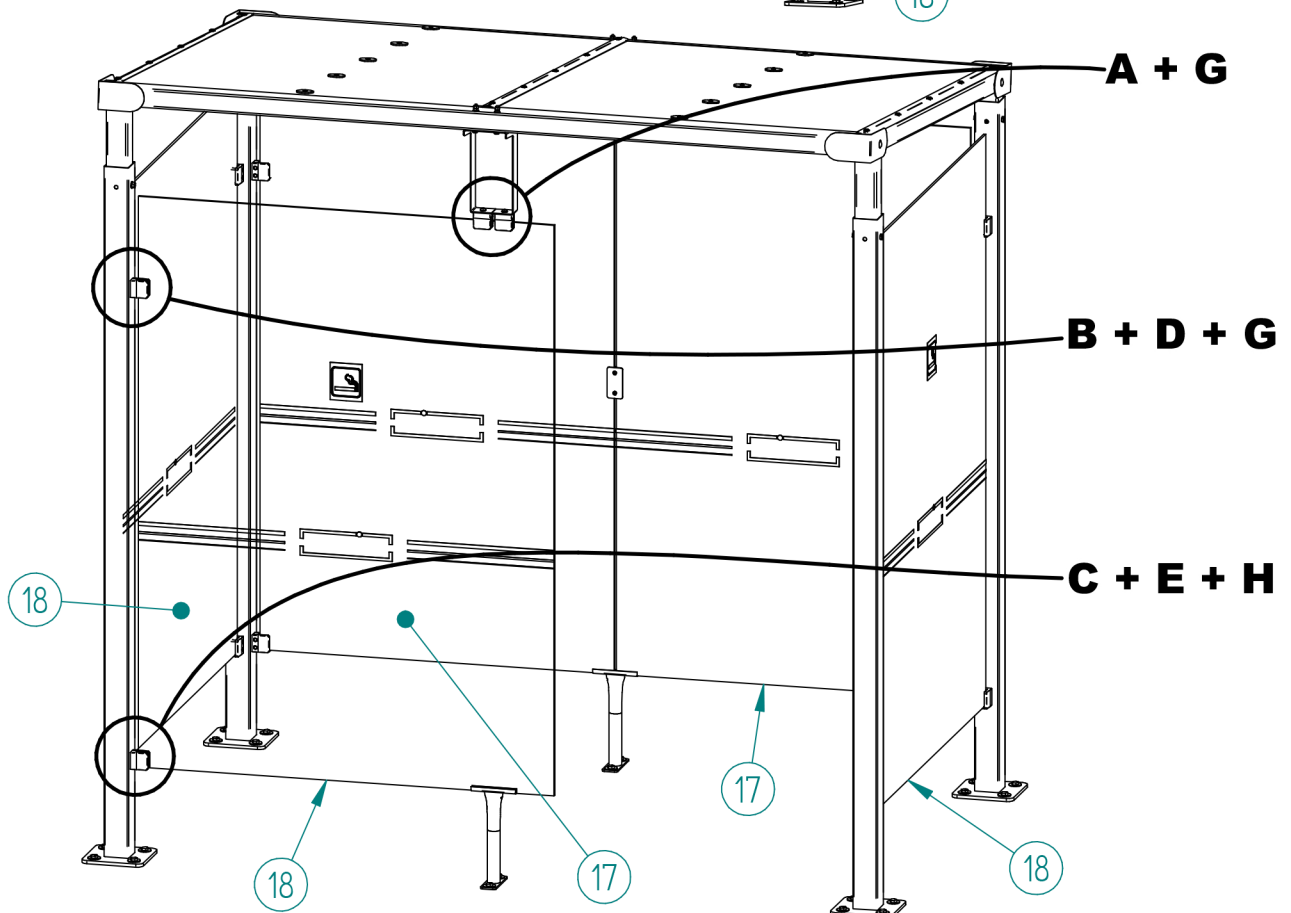
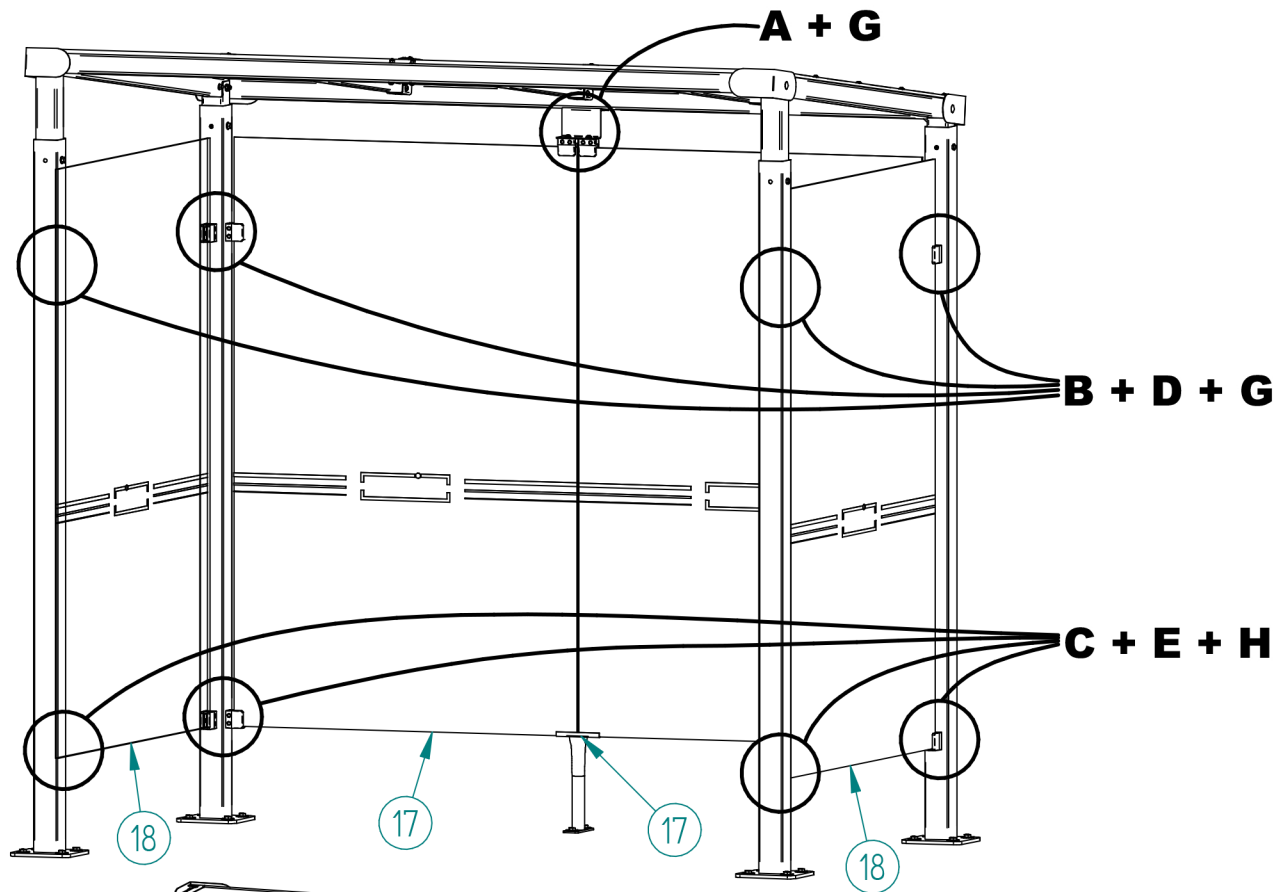

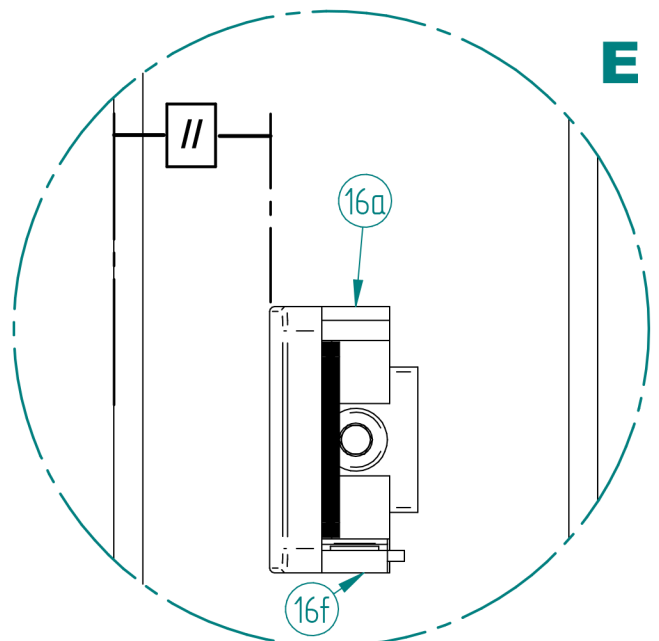
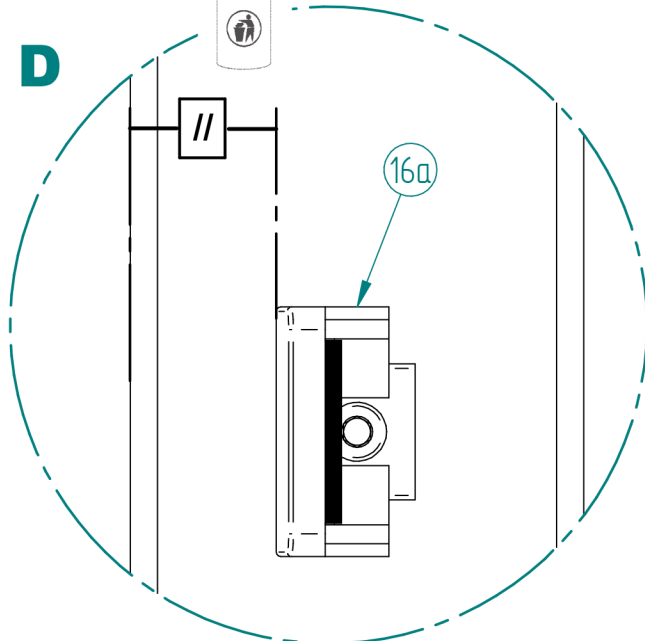
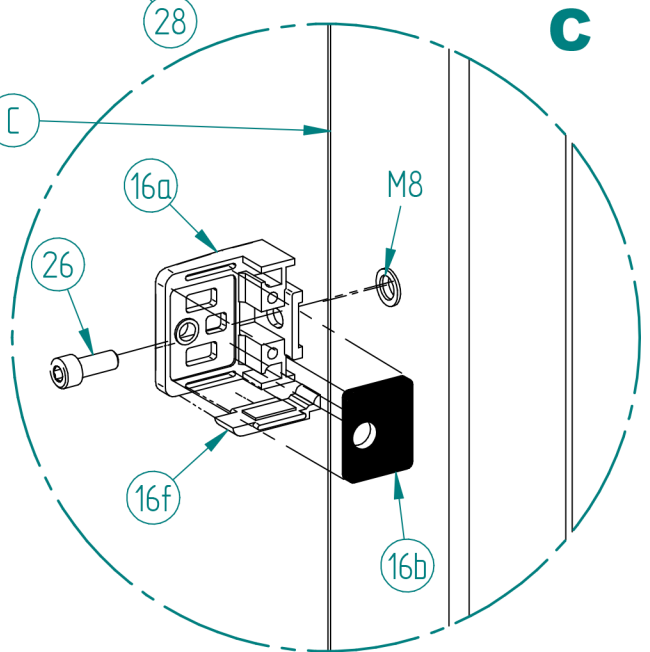
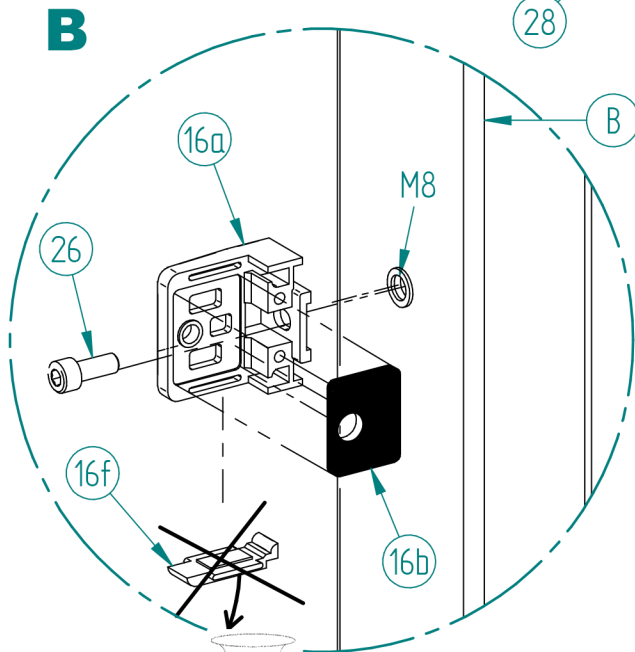
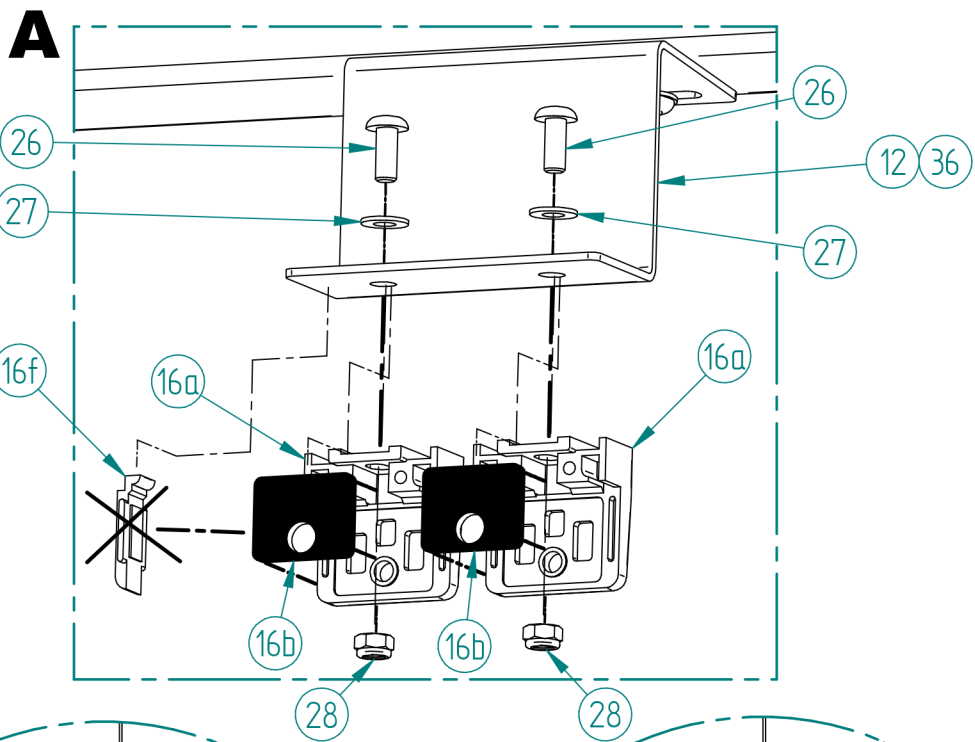

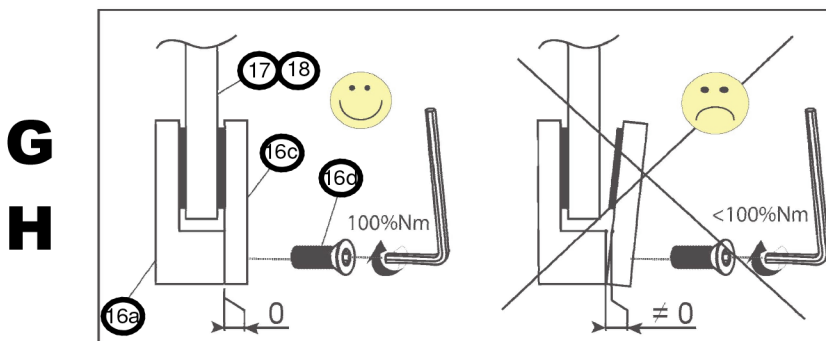
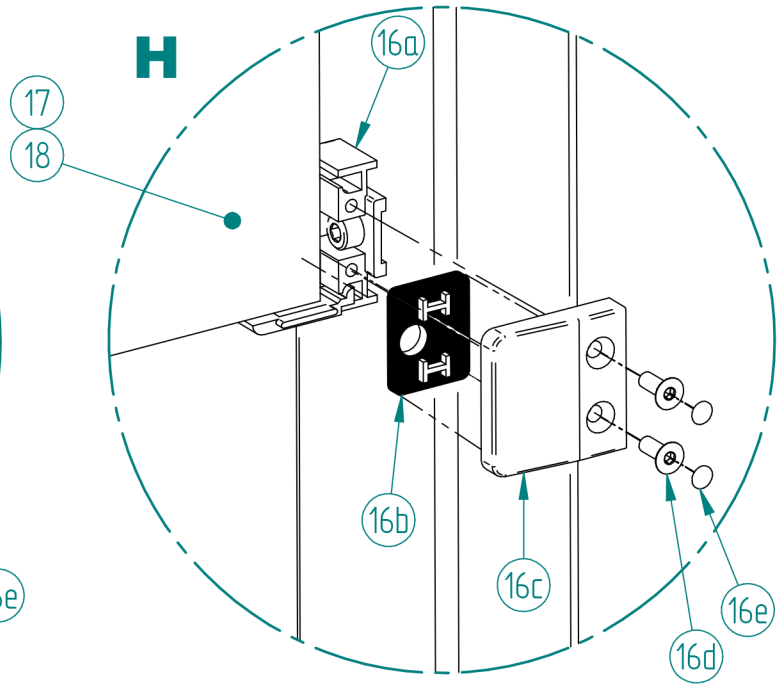
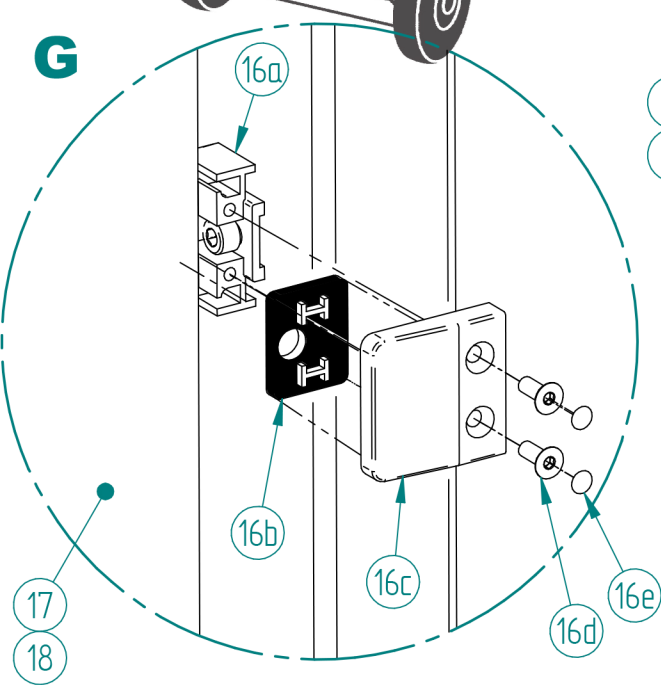
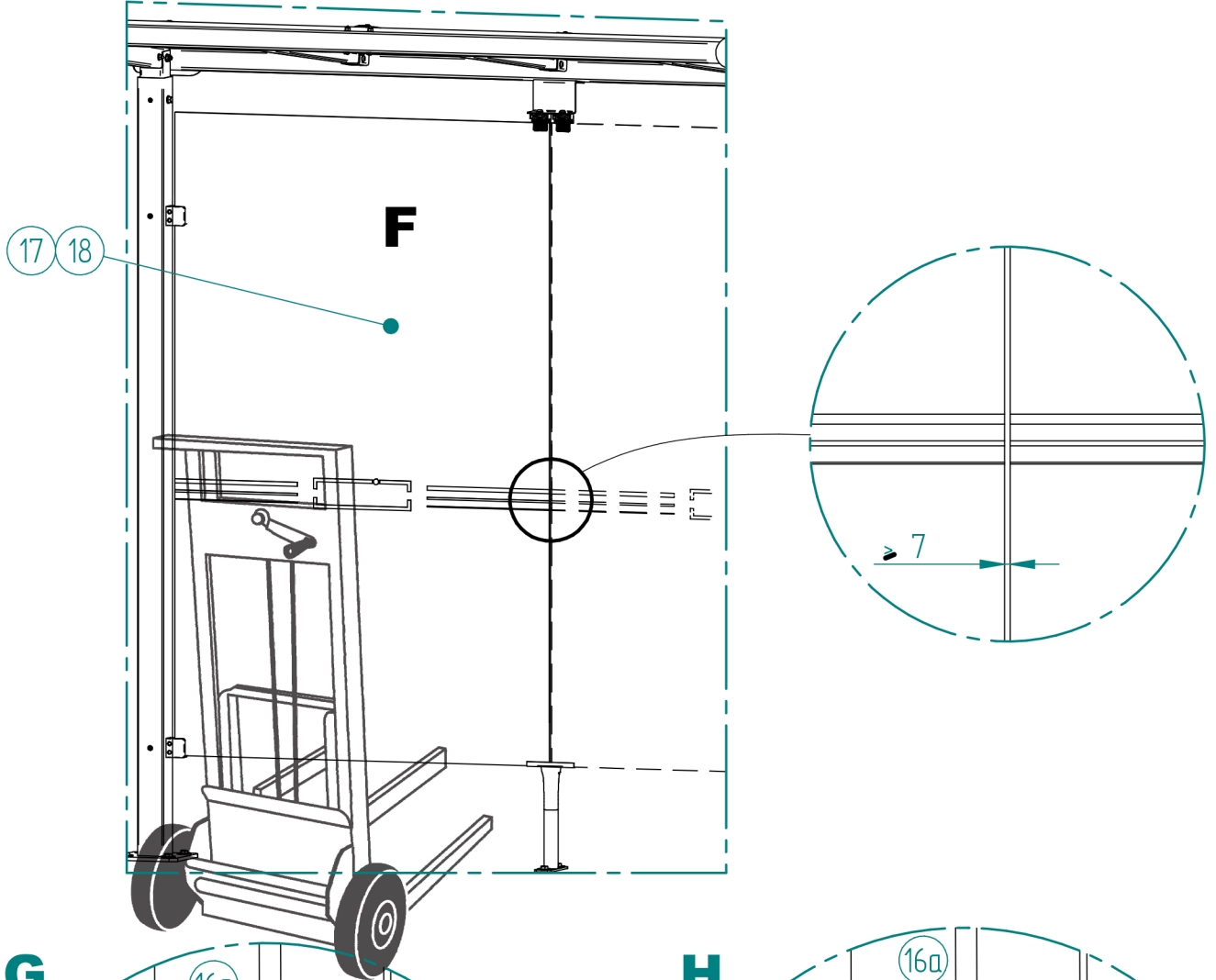

PINCE ENTRE BARDAGE

STATIONS BUS 5m et ABRIS FUMEURS - Réf.SFI529301.B

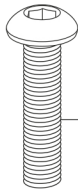
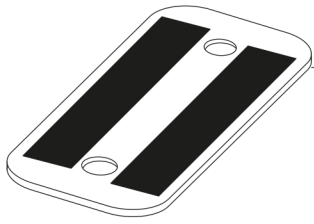

E1 (x 2)

100x50
SFI 529301.51

E5 (x 2)

BHC M6 x 25
ACC22135



E6 (x 2)

L 6 - ACC 18081

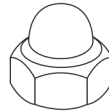

E4 (x 2)

HFr M6 - ACC 05036

Montage **A** : Bardage en verre

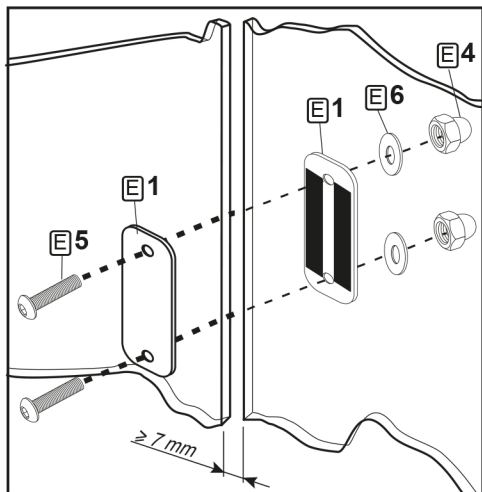
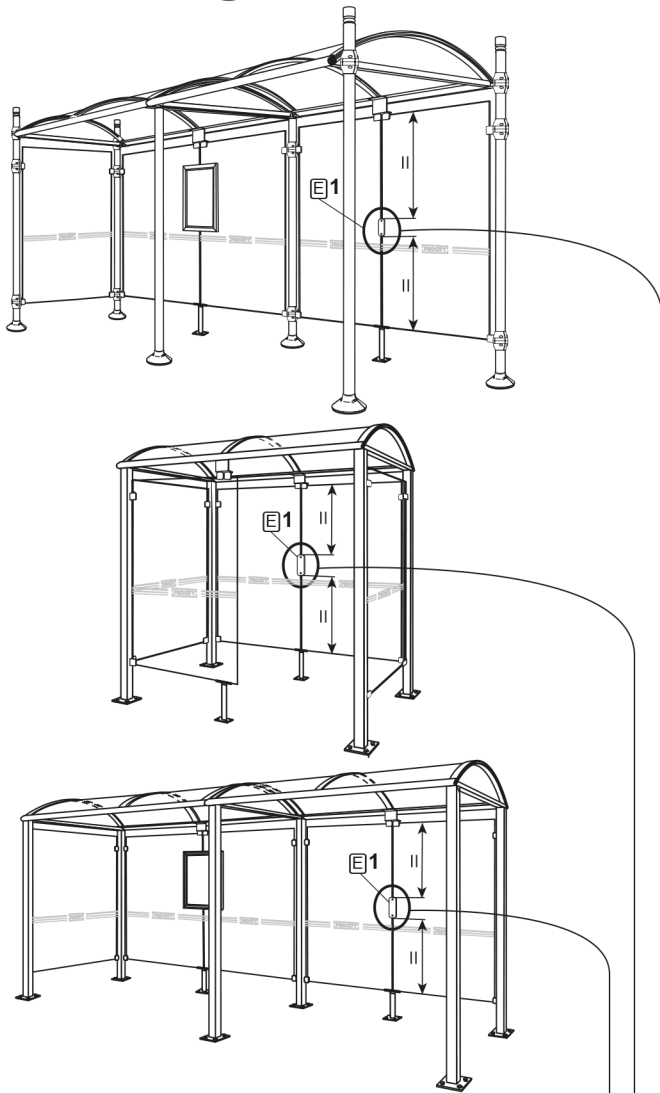

Montage **B** : Bardage en polycarbonate

